

MOTECH MOTOR CO., LTD

Product Name

Hybrid Stepper Motor
MT-1703HSM168RE

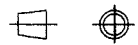

Rev B

Made by

P.T

Approve

Martin

Date

11/10/2017

E3D SKU: MT-1703HSM168RE

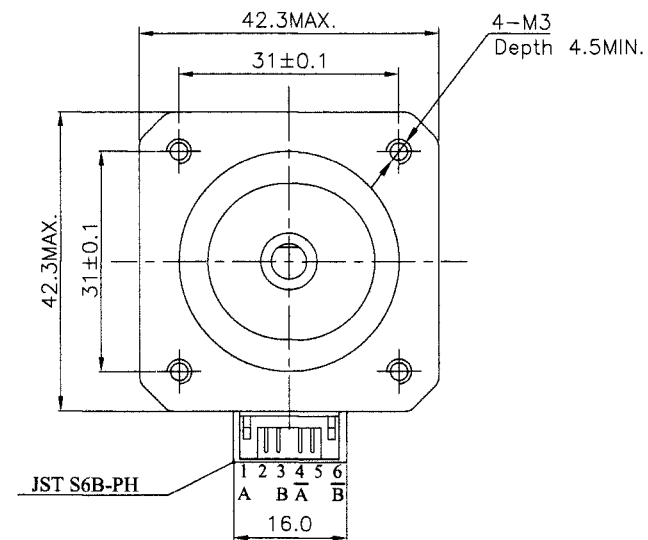
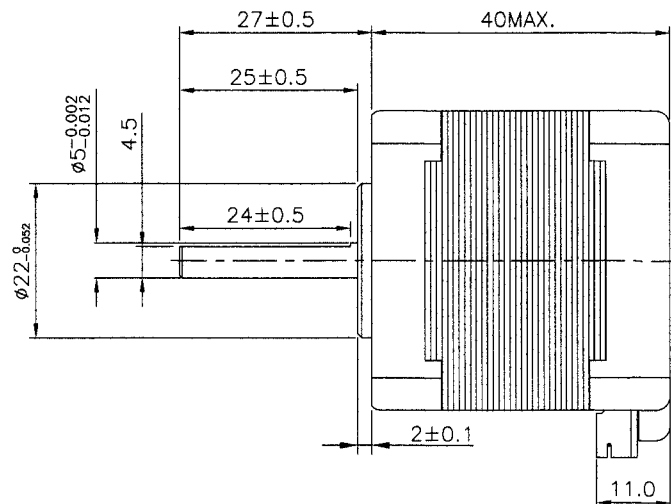

| Items | Specs | Items | Specs |
|------------------|-------------------------|-----------------------|--------------------|
| Phase Number | 2 phases | Step Angle | 0.9°±5% |
| Rated Voltage | 2.8 VDC | Rated Current | DC 1.68 A / Phase |
| Resistance(20℃) | 1.65±10% Ω / phase | Inductance | 3.6±20% mH / Phase |
| Holding Torque | ≥ 3.5 Kg-cm(48.6 Oz.in) | Detent Torque | 220 g-cm REF. |
| Rotate Direction | ABAB CW | MAX Starting PPS | 2500 PPS |
| MAX slewing PPS | 2500 PPS | Insulation Resistance | ≥100 MΩ(DC 500V) |
| HI POT | AC600V/1mA/1S | Insulation Class | Class B |
| Rotor Inertia | 54 g.cm ² | Weight | 0.28 Kg REF. |

Wiring Diagram

